



Isn't it just darling? It would be cute on the end of a bed too!

Shanty
CHIC



here's from Whitney (<http://www.shanty-2-chic.com/2014/01/diy-storage-bench.html>):

I loved making this cute little bench! The drawers are perfect storage, and it's also a great project if you are new to making drawers and attaching drawer slides. [I gave some more tips on how I attach my drawer slides in my post... http://www.shanty-2-chic.com/2014/01/diy-storage-bench.html](http://www.shanty-2-chic.com/2014/01/diy-storage-bench.html)) Really they are much easier than they look! The whole thing cost me around \$125 to build, which is much better than the \$600 Pottery Barn wants for theirs before shipping. I like our version better anyway ;-)! And, I think it's perfect for any room in the house!

Thanks Whitney!

Before we get to the plans, please take a second to check out [lots more photos, building and finishing details over a Shanty2Chic. \(http://www.shanty-2-chic.com/2014/01/diy-storage-bench.html\)](http://www.shanty-2-chic.com/2014/01/diy-storage-bench.html)

Plans follow!

Before we get to the plans, please take a second to check out [lots more photos, building and finishing details over at Shanty2Chic. \(http://www.shanty-2-chic.com/2014/01/diy-storage-bench.html\)](http://www.shanty2chic.com/2014/01/diy-storage-bench.html)

Plans follow!

XO Ana + Family

Shopping List:

1 - 2x2 @ 6 feet long

1 - 1x12 @ 6 feet long

1 - 1x2 @ 6 feet long

2 - 1x3 @ 10 feet long

3 - 1x6 @ 8 feet long

1 - 1x4 @ 6 feet long

1 - 1x8 @ 4 feet long

2x4 sheet of 1/4" plywood for drawer bottoms

2 sets of 15" drawer slides (euro bottom corner mounts)

2 knobs or handles

1 1/4 inch finish nails

[1-1/4" Pocket Hole Screws \(http://www.amazon.com/gp/product/B0006444U2/ref=as_li_tl?ie=UTF8&camp=1789&creative=390957&creativeASIN=B0006444U2&linkCode=as2&tag=knooffwoo-20&linkId=5AJJGUAWGYX2TT7E\)](http://www.amazon.com/gp/product/B0006444U2/ref=as_li_tl?ie=UTF8&camp=1789&creative=390957&creativeASIN=B0006444U2&linkCode=as2&tag=knooffwoo-20&linkId=5AJJGUAWGYX2TT7E)

Tools:

measuring tape

square

pencil

safety glasses

hearing protection

[Kreg Jig \(http://www.kregtool.com/files/anawhite/anawhite.asp\)](http://www.kregtool.com/files/anawhite/anawhite.asp)

[Drill \(https://www.ryobitools.com/power-tools/products/details/537\)](https://www.ryobitools.com/power-tools/products/details/537)

[Circular Saw \(https://www.ryobitools.com/power-tools/products/details/92\)](https://www.ryobitools.com/power-tools/products/details/92)

[Jigsaw \(https://www.ryobitools.com/power-tools/products/details/612\)](https://www.ryobitools.com/power-tools/products/details/612)

[Miter Saw \(https://www.ryobitools.com/power-tools/products/details/636\)](https://www.ryobitools.com/power-tools/products/details/636)

[Brad Nailer \(https://www.ryobitools.com/power-tools/products/details/552\)](https://www.ryobitools.com/power-tools/products/details/552)

[Random Orbital Sander \(https://www.ryobitools.com/power-tools/products/details/187\)](https://www.ryobitools.com/power-tools/products/details/187)

General Instructions:

Please read through the entire plan and all comments before beginning this project. It is also advisable to review the Getting Started Section. Take all necessary precautions to build safely and smartly. Work on a clean level surface, free of imperfections or debris. Always use straight boards. Check for square after

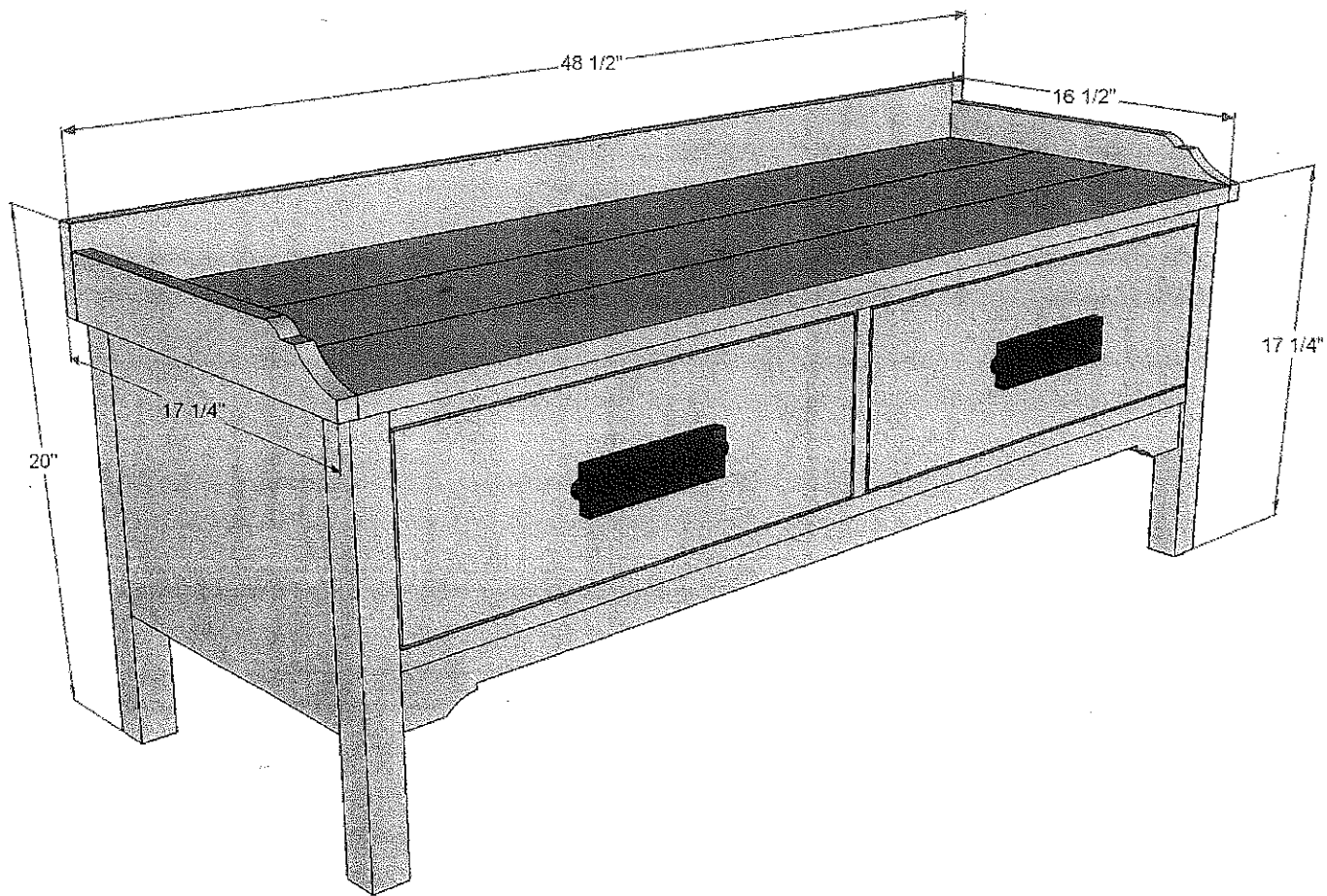

Material List:

- 2x2 @ 16-1/2" (legs)
- 1x12 @ 13-3/4" (sides)
- 1x12 @ 44" (back)
- 1x2 @ 44" (front trim)
- 1x2 @ 7-1/2" (front center trim)
- 1x3 @ 44" (front base trim)
- 1x3 @ 14 1/2" (center drawer cleat)
- 1x3 @ 13 3/4" (side drawer cleats)

RAWER

- 1x6 @ 15"
- 1x6 @ 19-1/8" (cut to fit!)
- 1/4" plywood @ 20 5/8" x 15" (cut to fit!)
- 1x8 @ 21 3/8" (cut to fit!)

TOP

- 1x6 @ 47"

2 - 1/4" plywood @ 20 5/8" x 15" (cut to fit!)

2 - 1x8 @ 21 3/8" (cut to fit!)

TOP

3 - 1x6 @ 47"

2 - 1x3 @ 16 1/2"

1 - 1x4 @ 48 1/2"

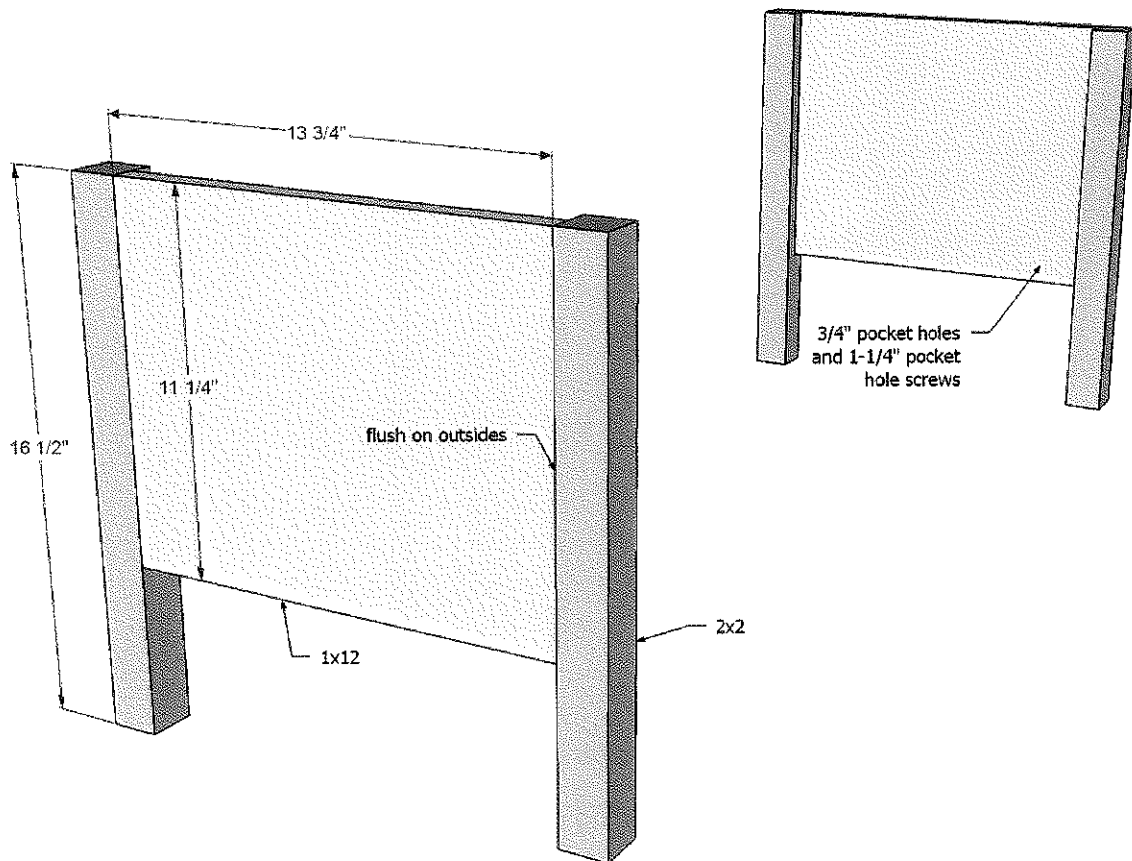

Step 1:

Start by building the two sides. Note that the 1x12 boards are expected to be 11-1/4" wide - measure yours and confirm - if not, adjust plans as necessary.

NOTE: You may wish to drill 3/4" pocket holes facing upward on the 1x12s for attaching the bench top in later steps.

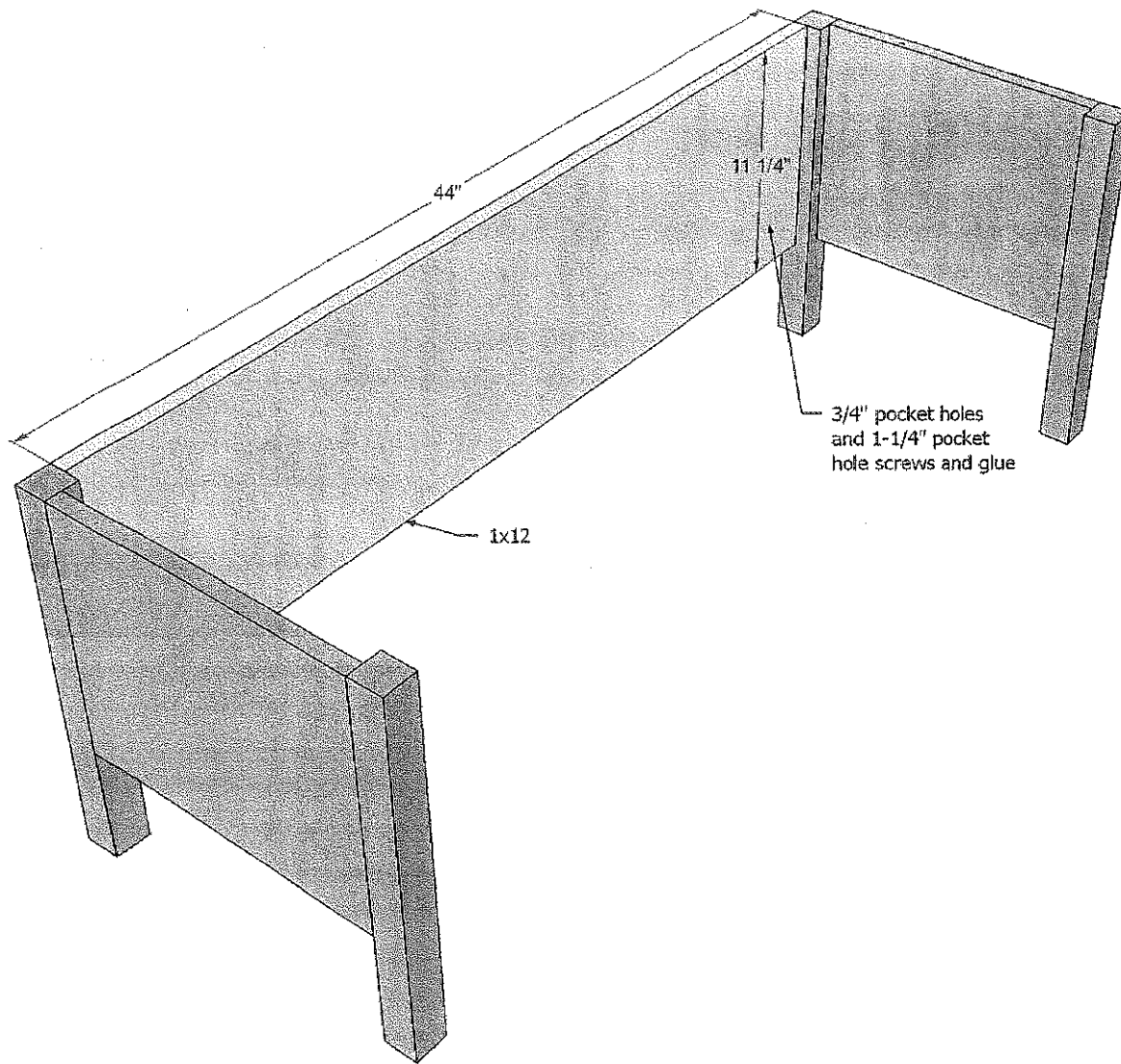

step 2 Instructions:

Attach the back to the bench, same as you did the side panels.

NOTE: You may wish to drill 3/4" pocket holes facing upward on the 1x12s for attaching the bench top in later steps.

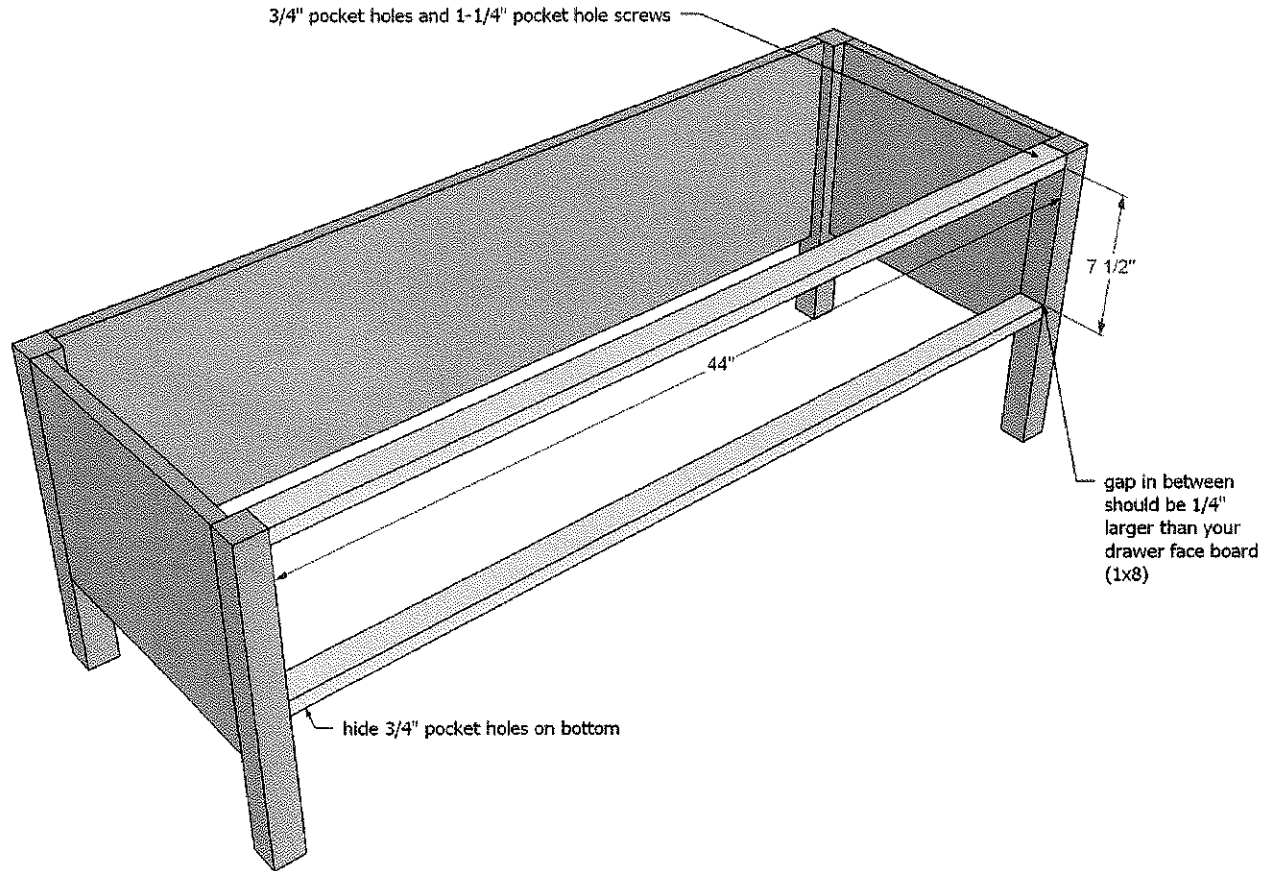

Step 3 Instructions:

Attach the two 1x2 front trim pieces to the bench legs. Note that the drawer faces (1x8s) are expected to be 7-1/4" wide - measure and confirm - the spacing between these 1x2s should be 1/4" more in with than your 1x8 drawer faces.

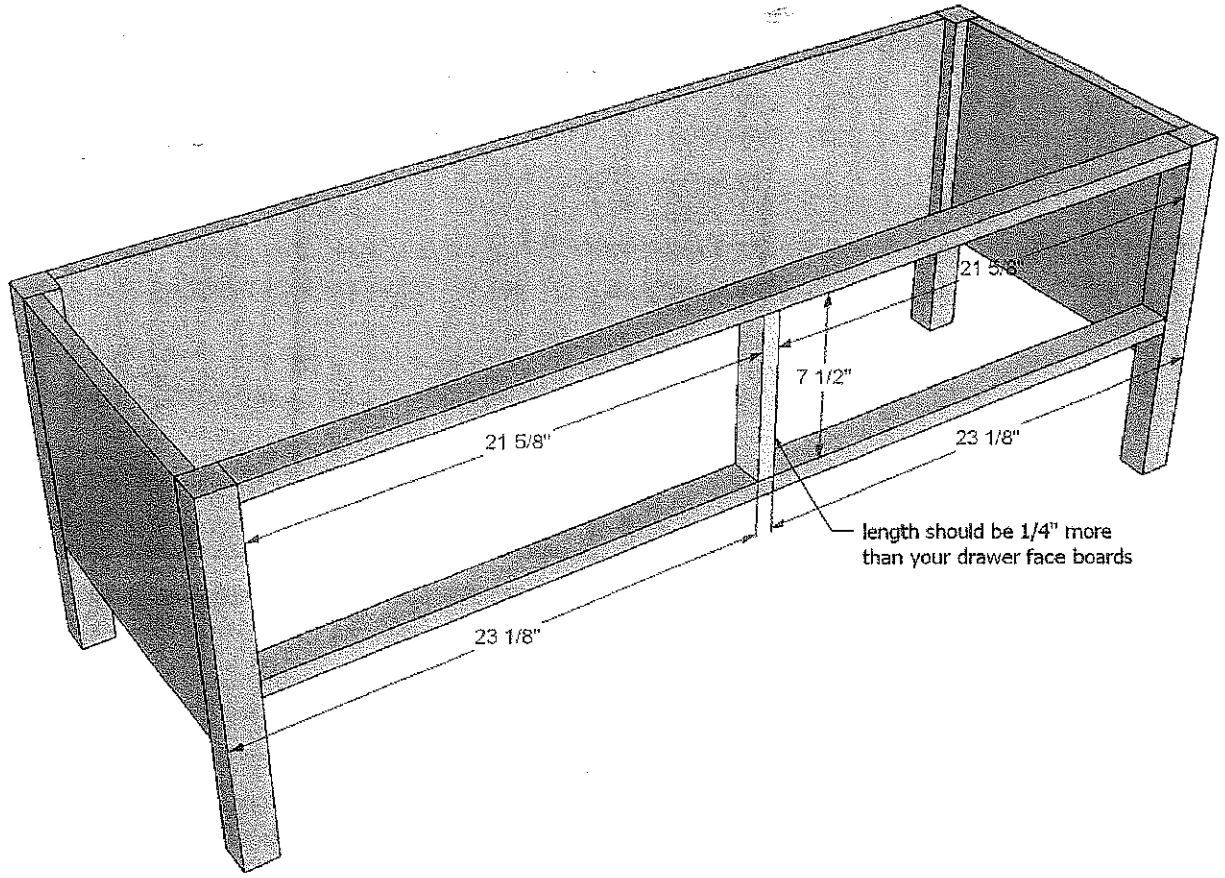

tep 4 Instructions: Add the center divider between the drawers.

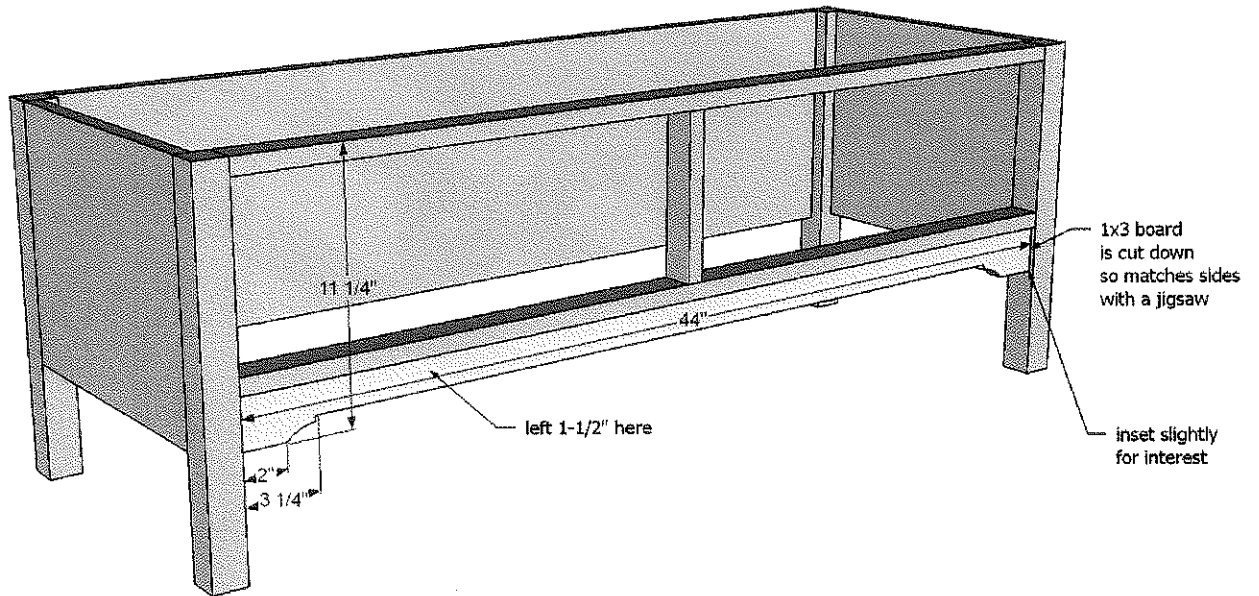

Step 5 Instructions: Then finish off the base with a decorative 1x3, cut out with a jigsaw.

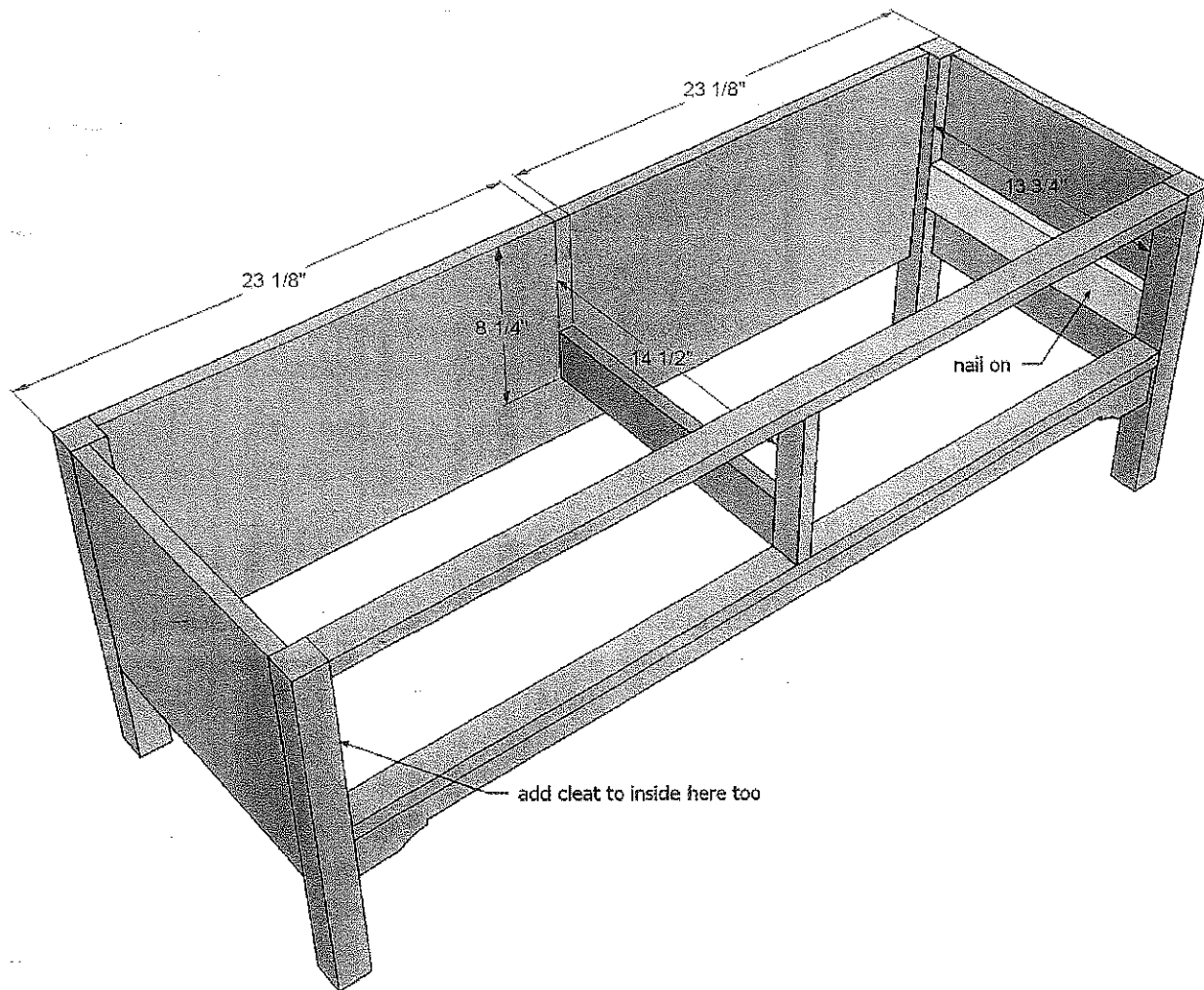

step 6 Instructions:

These cleats are for attaching drawer slides. Use pocket holes for attaching center cleat and 1-1/4" finish nails for attaching side cleats.

OTE: you can also add a 5th leg to the center under the center cleat if you find it necessary for heavier loads.

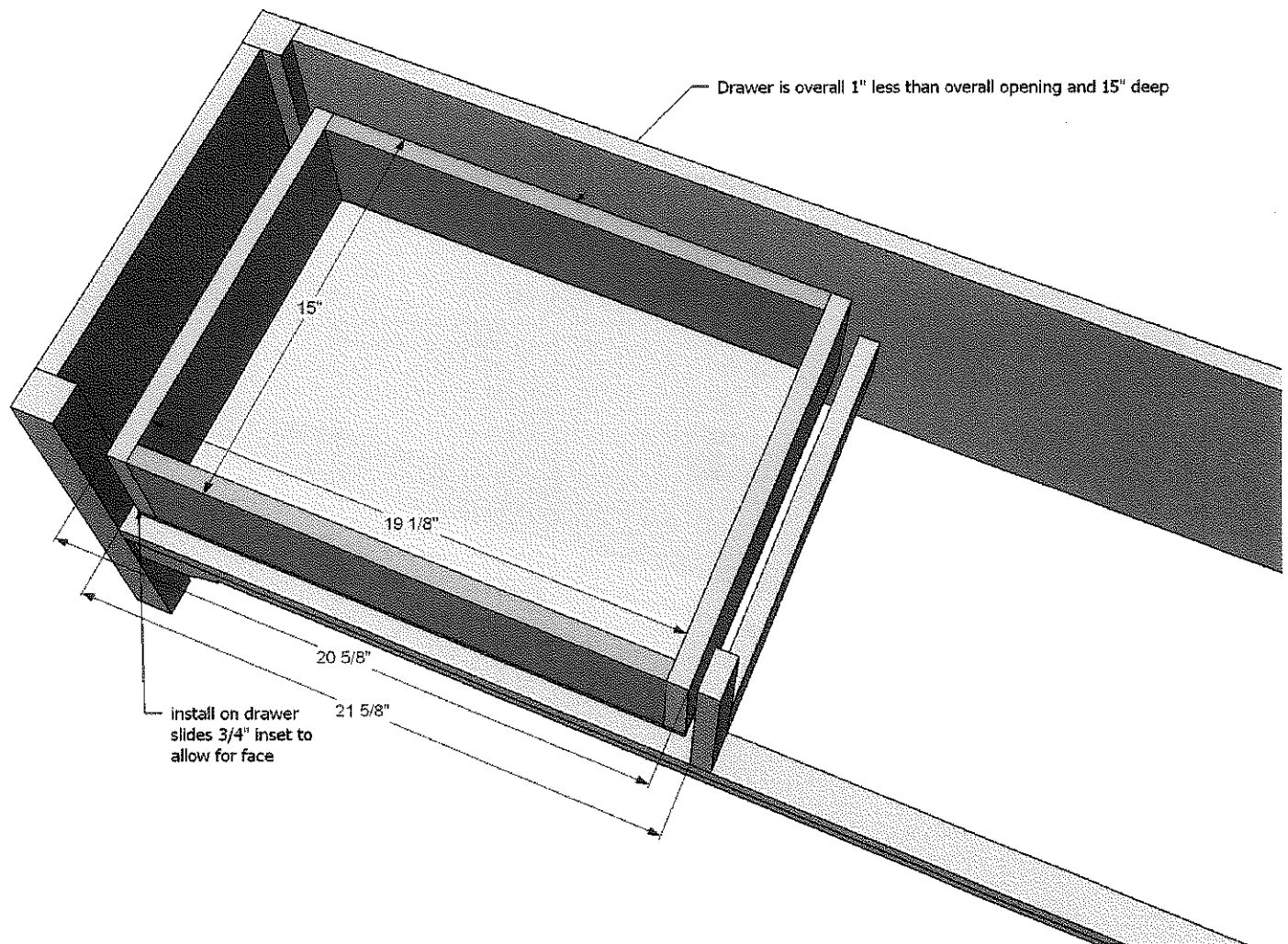

Step 7 Instructions:

Drawers should always be build to the dimensions of the opening and also the drawer slides you are using.

Make sure you install the drawer inset 3/4" to allow for the drawer face (next step).

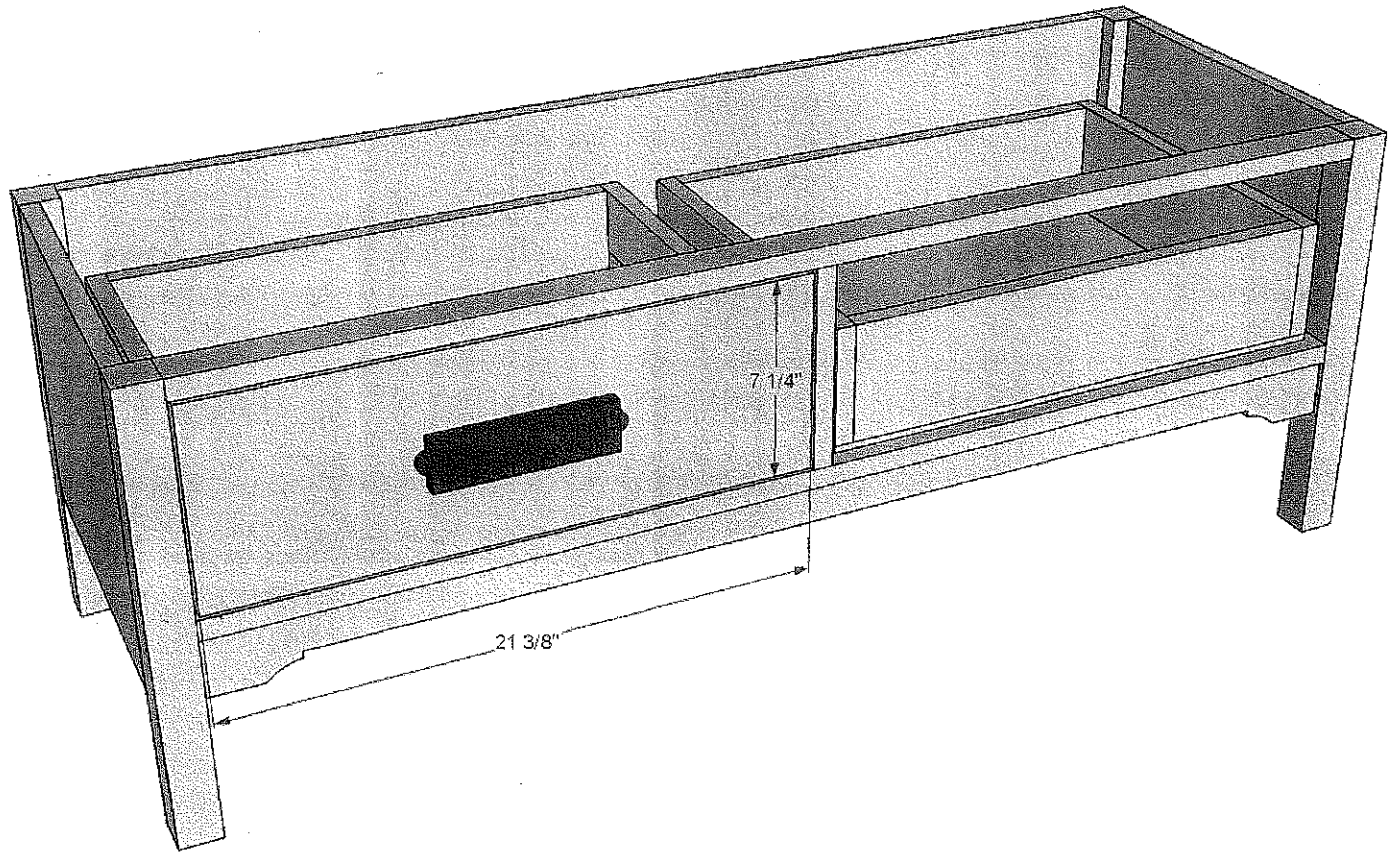

step 8 Instructions:

The drawer face can be nailed on from outside or screwed on (1-1/4" fasteners) from inside. It may be easier to attach your knob or handle before attaching the face to the drawer.

Leave an 1/8" gap around all sides of the drawer face.

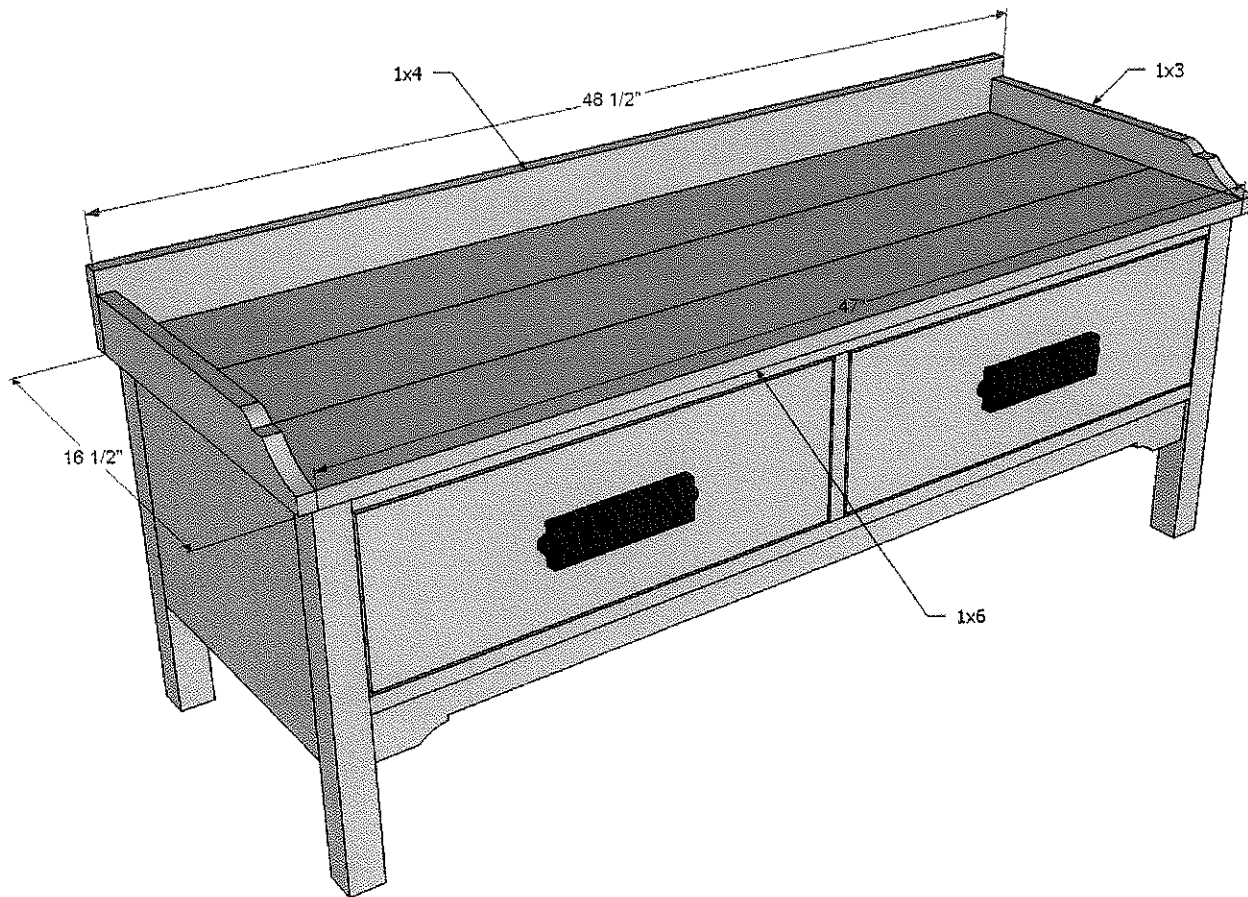

Step 9 Instructions:

For the bench top, use 3/4" pocket holes to attach the 1x6s together. Then add the end pieces, and finally the back piece. Attach to top of bench by either using pocket holes drilled facing upward in the 1x12 sides and back, or through the top.

Preparation Instructions:

Fill all holes with wood filler and let dry. Apply additional coats of wood filler as needed. When wood filler is completely dry, sand the project in the direction of the wood grain with 120 grit sandpaper. Vacuum sanded project to remove sanding residue. Remove all sanding residue on work surfaces as well. Wipe project clean with damp cloth. It is always recommended to apply a test coat on a hidden area or scrap piece to ensure color evenness and adhesion. Use primer or wood conditioner as needed.

Project Type: [Bench \(/category/plans/project-type/bench\)](/category/plans/project-type/bench)

Estimated Cost: [\\$150 - \\$200 \(/category/plans/estimated-cost/150-200\)](/category/plans/estimated-cost/150-200)

Room: [entry way \(/category/plans/room/entry-way\)](/category/plans/room/entry-way)

Skill Level: [Advanced \(/category/plans/skill-level/advanced\)](/category/plans/skill-level/advanced)